

One Year Unconditional Warranty

If for any reason, this ProMaster product fails within ONE YEAR of the date of purchase, return this product to your ProMaster dealer and it will be exchanged for you at no charge. ProMaster products are guaranteed for ONE FULL YEAR against defects in workmanship and materials. If at any time after one year, your ProMaster product fails under normal use, we invite you to return it to ProMaster for evaluation.



Vertical Control
Power Grip

FITS NIKON D500

CODE 9217

Congratulations on your purchase of the ProMaster Vertical Control Power Grip for Nikon D500. This battery grip will provide longer shooting times for your camera, comfortable photography when taking vertical-orientation shots, and a more stable overall camera rig which reduces the chance of shake and blur.

To ensure proper operation, please read this manual thoroughly before using the product.

This grip is specially designed for the Nikon D500 camera. It is equipped with an alternate shutter button and main dial for easy shooting in a vertical position. This battery grip can hold one EN-EL15 battery while a second EN-EL15 battery is used in the D500's battery chamber to extend your shooting time. This grip includes a secondary battery tray for powering the D500 by use of 8 AA alkaline or NiMH batteries.

Caution

- This product should only be used with compatible devices specified in this instruction sheet.
- Use ONLY the batteries and battery holder recommended.
- Cover the power terminals with the contact cap when not in use. This prevents electrical shorts caused by metal objects touching the terminals.
- When the battery holder is removed from the grip, remove the batteries or place the holder in a container to prevent electrical shorts caused by contact with other metal objects.
- The battery level may not display properly if batteries are inserted before attaching the grip to the camera.
- Remove batteries from the grip when not in use for an extended period.
- Do not disassemble or repair this product yourself. Doing so will void your warranty.
- Avoid water or extreme humidity and be sure to store in a cool, dry location.
- Do not dispose of in fire or extremely high temperature environment.
- Keep the product or parts away from children to avoid hazard from swallowing.

Part Names

- ① Protective Cover
- ② Holder for Protective Cover
- ③ AF-ON button
- ④ Main Command Dial
- ⑤ Multi Selector
- ⑥ Attachment Wheel
- ⑦ Cover for optional AC cord
- ⑧ Battery Tray Chamber
- ⑨ Battery Tray
- ⑩ Battery Holder Release Handle
- ⑪ Power/Signal Contacts
- ⑫ Attachment Screw

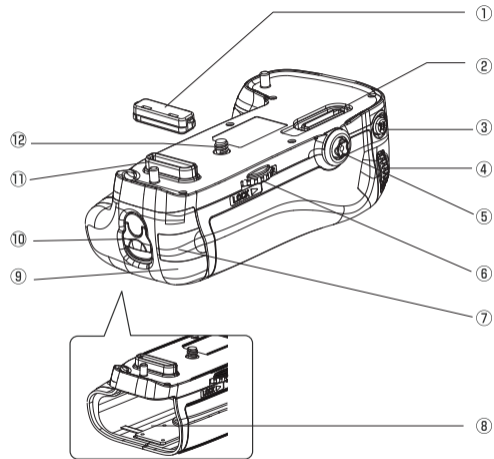

- ⑬ Shutter Button
- ⑭ Control Lock
- ⑮ Sub-command Dial
- ⑯ Tripod Socket
- ⑰ EN-EL15 Battery Tray
- ⑱ AA Battery Tray

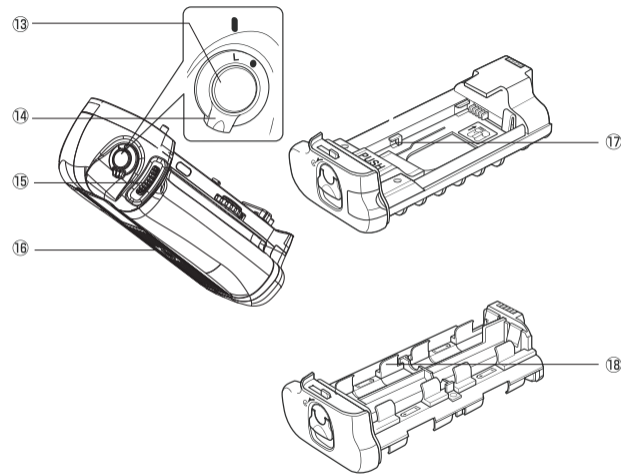

Attaching Your Camera

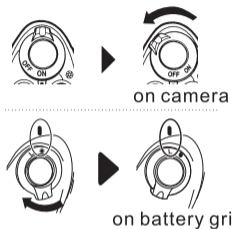

1. Please turn off the switch on the camera and ensure that the Control Lock (14) on the grip is in the “L” position before attaching.

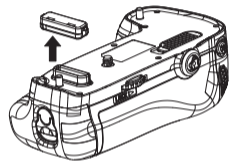

2. Remove the Protective Cover (1) from the battery grip.

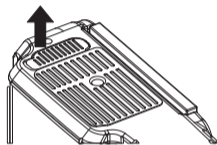

3. The contacts for the battery grip are on the bottom of the camera where they are protected by a contact cover. Remove the contact cover before mounting the grip.

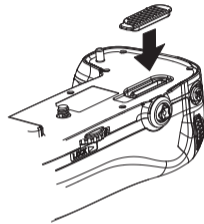

4. To prevent loss, place the Protective Cover (1) into the Holder for Protective Cover (2) for storage.

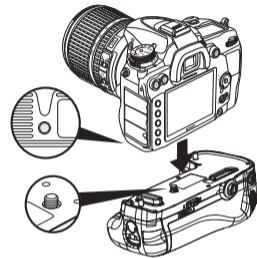

5. Align the Attachment Screw (12) with the camera's tripod socket.

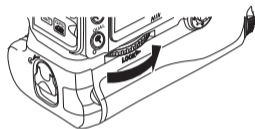

6. Turn the Attachment Wheel (6) in the direction of the LOCK arrow to tighten securely.

Installing The Batteries

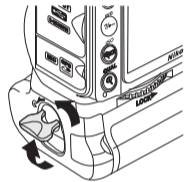

1. Ensure the camera is turned OFF and the Control Lock (14) on the grip is in the "L" position. Turn the Battery Holder Release Handle (10) counter-clockwise to unlatch it from the grip.

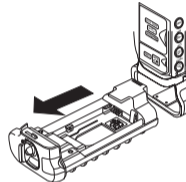

2. Remove the Battery Tray (9) from the grip.

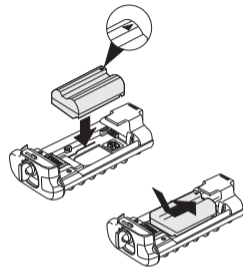

3. For EN-EL15 Li-ion batteries, match the power contacts of the battery with the contacts in the EN-EL15 Battery Tray (17).

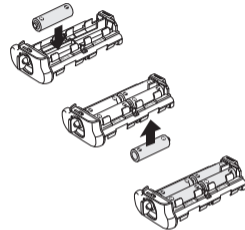

4. For AA batteries, place eight AA batteries of the same type into the AA Battery Tray (18) while ensuring they are in the correct orientation. Be sure not to mix old and new AA batteries.

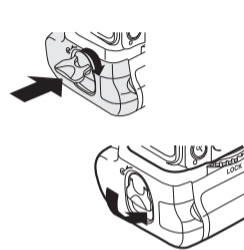

5. Insert the Battery Tray into the grip. Turn the Battery Holder Release Handle (10) clockwise to lock it into the grip. Turn on the camera and then switch the grip's Control Lock (14) to ON by rotating it away from the "L" position and lining up the two dots.

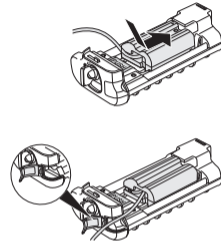

6. If you wish to use an AC adapter (sold separately) to power the camera, insert the adapter into the EN-EL15 Battery Tray (17) and open the Cover for Optional AC Cord (7) to allow the cord to pass through.

Specifications

Model	9217
Power Source	1 EN-EL15 battery or 8 AA alkaline or NiMH cells
Camera Compatibility	Nikon D500
Replacement for	MBD-17
Operating Temperature	0~40° C (32~104°F)
Dimensions	151 mm x 50 mm x 82 mm
Weight (without batteries) (grip + 1 tray)	8.1 oz / 230 g

* Approximate measurements

* All the trademarks are the property of their respective owners

* Specification and design are subject to change without notice

Operation and Use of the Grip

1. Your camera must be turned ON for the grip to operate. When your camera is ON the grip may be switched ON or OFF by using the Control Lock (14). Please note, the grip will continue to supply power to your camera whether the Control Lock (14) is ON or OFF. Setting the Control Lock (14) to OFF ("L" position) only disables the operation of the grip's camera controls.
2. At default settings, the battery in the camera's chamber will be used only after the battery in the grip is depleted. The Battery order option in the camera setup menu can be used to change the order in which the batteries are used.
3. Use the grip's Shutter Button (13) to comfortably auto focus and take photographs while holding your camera in a vertical position.
4. Use the Main Command Dial (4), Multi Selector (5), and Sub-command Dial (15), as you would on your camera.
5. Use the Tripod Socket (16) to mount your grip and camera to a tripod or quick release plate.